

W1 Edge

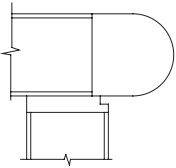

W2 Edge

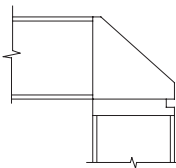

W3 Edge

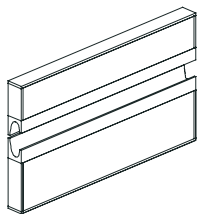

Flush wood pull is standard

## Characteristics

- Woodside is similar to Monterey with greater emphasis on the edge detail.
- With 21" and 24" deep returns, bridges and components, Woodside will address most clients' needs.
- With 3 edges to choose from, Woodside meets the style requirements of most office environments.

## Construction

- Top over end panel construction.
- Top is 1 1/4" thick.
- Edge detail on all four sides.
- Edge detail has mitered corners.
- Flush wood pulls standard on all pedestals.
- Hinged door cabinets (except hutches) have touch latch doors.
- One grommet 2 1/2" in each work surface is included in price, if grommet is requested.
- All shelves are 1 1/4" thick.