



Xchange—a new vision of the integrated office space—never forgets that your work is as individual as you are. Seamless linking of the many functions required of the modern office is enhanced by creative design that adapts new technological demands to your way of working. A palette of shapes and materials help you to create harmony and individuality in spaces both small or large, whether private office, work station, reception station or conferencing. **Your choice. Your view. Your vision.**

DESIGNED BY: JORGE LARRAÑAGA

XCHANGE XCHANGE

PRIVATE OFFICE >>>



WORKSTATIONS >>>



RECEPTION STATIONS >>>



CONFERENCING >>>





The three-piece top of the peninsula desk allows for combinations of different materials such as wood, glass and acrylic.



Hand-crafted glass pulls are available in three colors.



Different materials can be combined on hinge or sliding doors as an additional design accent.



WALL UNIT

Space is precious. Today's offices require flexibility to support fast-changing technology and, frequently, tighter office dimensions. The Xchange workwall is based upon an easily adaptable horizontal grid system that makes the most of available space. Change happens. When it does, Xchange can be retrofitted to meet new requirements.

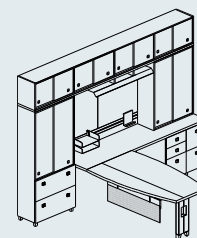
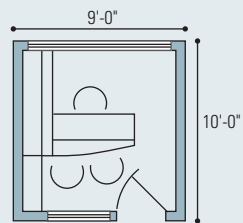

A

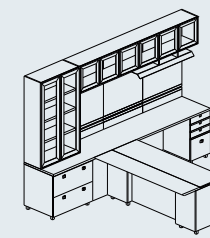

B

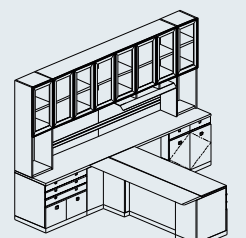

C



Paper management exists above, at, and below the work surface.



A wire management system provides power, data and voice access throughout the work surface.



Tack board/wood panel combinations offer an additional design element.



U-SHAPE WALL UNIT

With Xchange, personal control over how you organize your work has never been easier. Convenient paper management accessories can be located at each level of the system and adjusted to individual preference. Power, voice and data are accessible anywhere along the worksurface through simple removal of a wood tile. Xchange lets you work the way that works for you.

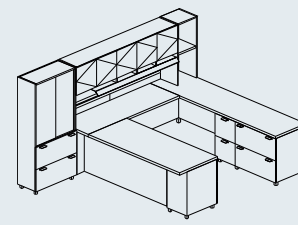
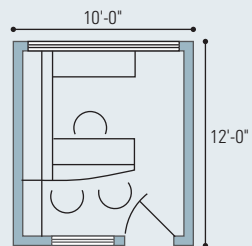

A

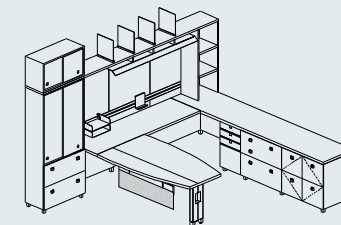

B

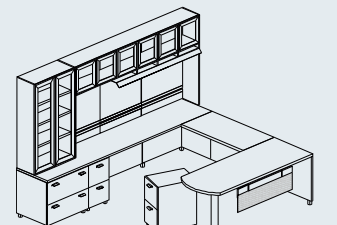

C



3-piece desktop with leather insert.



Sandblasted drawer front, hand-crafted glass pulls and makoree veneer.



WALL UNIT WITH DESK

Express yourself with Xchange. The option to use numerous shapes, finishes and materials, subtle or bold, in combinations or distinctly alone, inspires possibilities. Unique details such as individually hand-crafted knobs and desktops with inserts of different materials add breathing room for your creativity. Proportional geometrics—lines and squares of our grid system—give a rhythm and balance to all Xchange products.

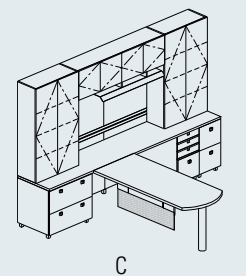
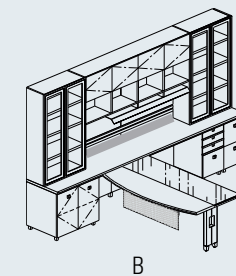
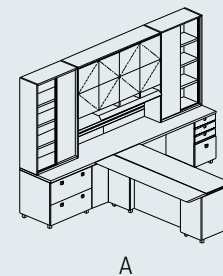



An accessory track holds items to organize your workstation.



Panel options include all wood, glass or acrylic windows, and pass-through windows.



WORKSTATIONS

Everyone wants a window office. Xchange workstations allow you to bring this symbol of the private office, along with other casegoods features, to open space environments. Workstations can be specified in side-to-side, or back-to-back, configurations. The 4-inch recessed structure of Xchange allows for easy wire management in either configuration. This can be accessed through a removal wood tile above the work surface and a removable modesty panel below the work surface. Workstations can be customized to meet architectural conditions.

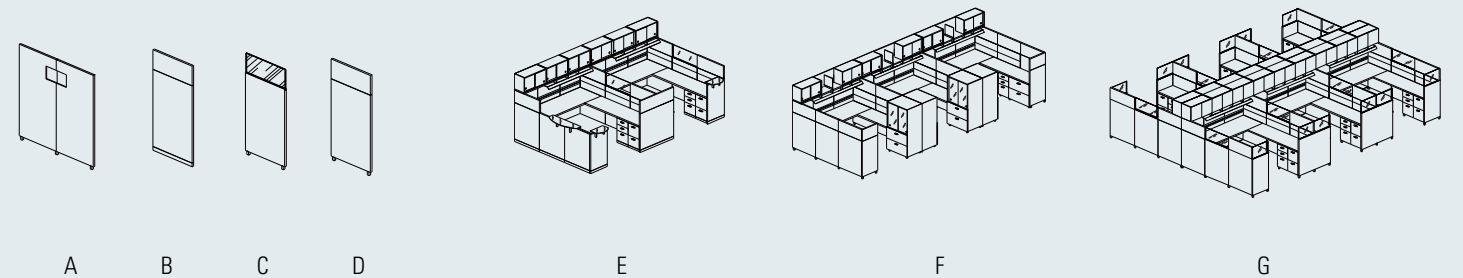



Glass transaction counter with brushed aluminum bracket.



Storage credenza.



RECEPTION STATIONS AND CONFERENCING

First impressions are important. That's why reception station and conference room design are so intrinsic to the success of a cohesive office layout. The design vocabulary that defines Xchange can also be applied to reception stations and conferencing products, creating a unified office identity.

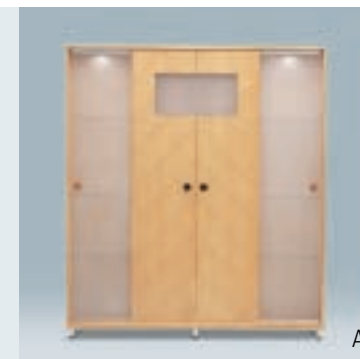

A

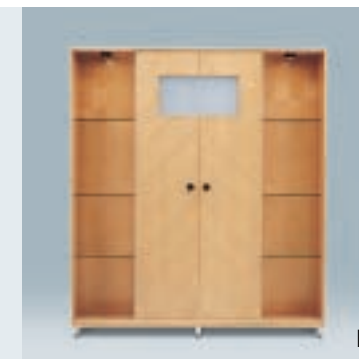

B



C

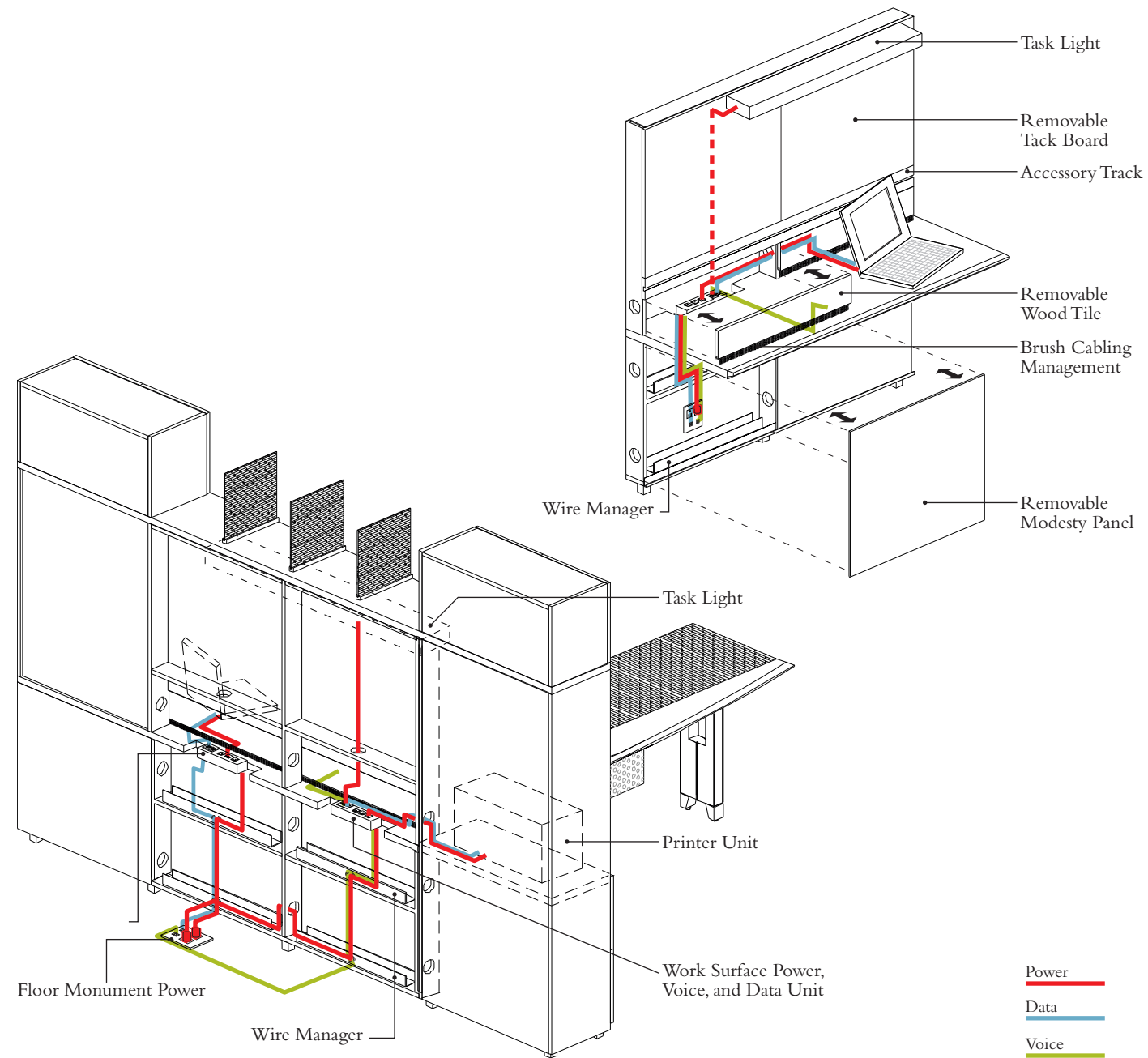

WIRE MANAGEMENT

Xchange provides integrated wire management accessible throughout the system as indicated in the above drawing. This is accomplished in two unique ways. The first involves removable six-inch horizontal tiles located below the accessory track. This allows easy access to voice, data and power anywhere along the work surface. The second includes removable modesty panels, which also achieve easy access to voice, data and power. In addition, wire managers run behind the modesty panel for excess cable. These two concepts can be used together or separately for cost reduction.

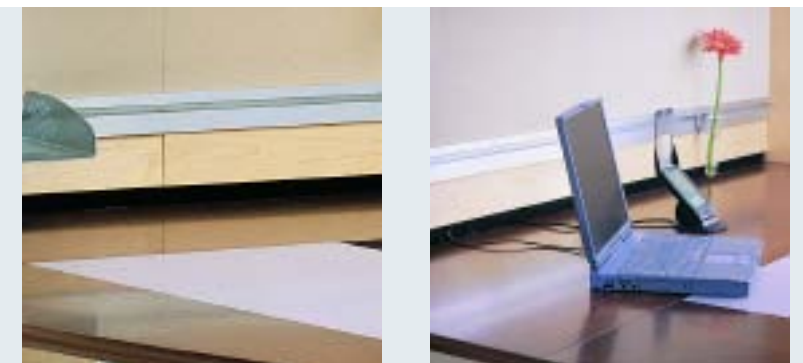



4611 Malat Street >>> Oakland, CA 94601 >>> tel: 510.534.4930 >>> fax: 510.534.6389 >>> www.woodtechgreen.com